

33

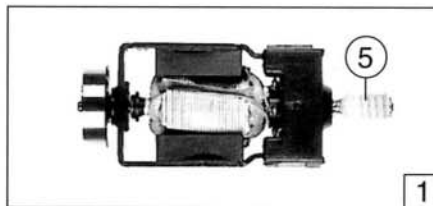

31



1



21

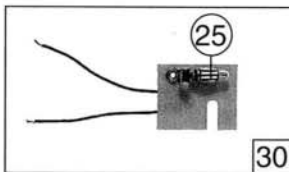

30



20

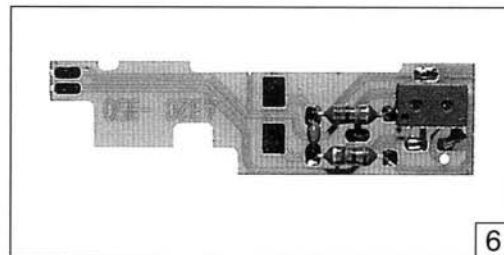

6

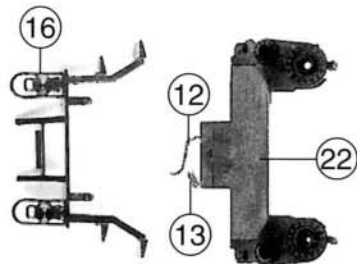

12

13

16

22

27 o. Abb. / no ill.
Schiebereinsatz
Slide insert

28 o. Abb. / no ill.
Zylinderschutzrohr
Protection tube



14

15



32

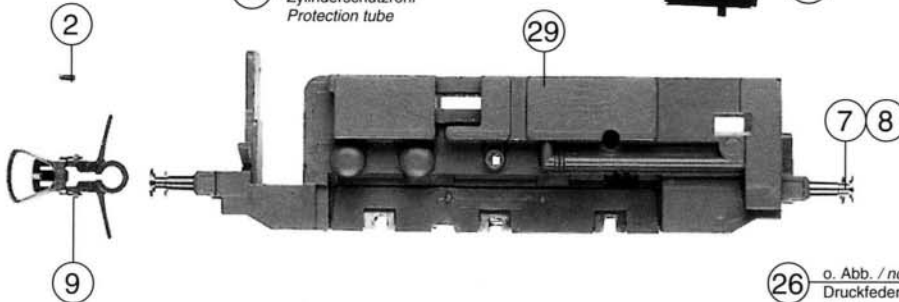

2

29

7

8

9

26 o. Abb. / no ill.
Druckfeder
Spring

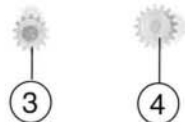

3

4

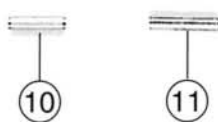

10

11

Pos.-Nr.	Text	Art.-Nr.	Preis-Gruppe
1	Motor Motor	85110	57
2	Schraube M 1,6 x 5 Screw M 1,6 x 5	85702	3
3	Zahnrad z=14r; m 0,4 Gear T=14r; m 0,4	86403	2
4	Zahnrad z=17i; m 0,4 Gear T=17i; m 0,4	86408	2
5	Schnecke m 0,4 Worm m 0,4	86713	5
6	Platine komplett Printed circuit assembly	87831	42
7	Puffer gewölbt Buffer vaulted	88504	4
8	Puffer flach Buffer flat	88505	4
9	Kupplung Coupling	89203	5
10	Achse 2,6 x 9,3 Axle 2,6 x 9,3	89700	2
11	Achse 2,6 x 11,5 Axle 2,6 x 11,5	89701	2
12	Seuthe Kontakt 1 Seuthe contact 1	89974	4
13	Seuthe Kontakt 2 Seuthe contact 2	89975	4
14	Hebel links Lever left	91075	2
15	Hebel rechts Lever right	91076	2
16	Laternensatz Lantern	95080	8
17	Dachlüfter Roof vent	95082	2
18	Fenster vorne Glazing front	95083	4
19	Fenster hinten Glazing back	95084	2
20	Motorspange Motor clamp	106663	3
21	Dampfentwickler Boiler	106664	35
22	Zylinderblock Cylinder block	106653	20
23	Seuthehalter Seuthe support	106912	5
24	Filzscheibe Felt slice	106913	2
25	Glühlampe 16 V Light bulb 16 V	109088	12
26	Druckfeder Spring	86209	2
27	Schiebereinsatz Slide insert	107249	2
28	Zylinderschutzrohr Protection tube	107250	2
29	Grundrahmen Loco frame	108973	20
30	Lampenplatte Bulb board assembly	108974	29
31	Lichtleitersatz Glazing set	108975	8
32	Lichtabdeckung Light cover	108976	3
33	Gehäuse Betr.Nr. 80 017 Body Betr.No. 80 017	109231	46