

Pos. Nr.	Text	Art.-Nr.	Preisgruppe
1	Halfring <i>Traction tyre</i>	85612	17
2	FK-Schraube <i>FK-screw</i>	85704	3
3	Schraube 2,2 x 6 <i>Screw 2,2 x 6</i>	85800	2
4	Schraube M 1,6 x 6 <i>Screw M 1,6 x 6</i>	85811	2
5	Beilagscheibe <i>Washer</i>	86114	2
6	Feder <i>Spring</i>	86204	2
7	Schneckenrad <i>Worm gear</i>	86413	4
8	Zahnrad z=17 / 0,4 G <i>Gear T=17 / 0,4 G</i>	86418	2
9	Zahnrad z=23; m 0,4 <i>Gear T=23; m 0,4</i>	86425	2
10	Zahnrad z=29; m 0,4 <i>Gear T=29; m 0,4</i>	86468	2
11	Schnecke <i>Worm</i>	86702	5
12	Kardankugel <i>Cardan ball</i>	87153	2
13	Radkontakt <i>Wheel current contact</i>	89958	3
14	Radsatz ohne Halfring <i>Wheelset without traction tyre</i>	90891	18
15	Radsatz komplett <i>Wheelset assembly</i>	90935	16
16	Radsatz mit 1 Halfring <i>Wheelset with 1 traction tyre</i>	90936	20
17	Schneckendeckel <i>Worm cover</i>	94707	5
18	Drehgestell hinten komplett <i>Rear bogie assembly</i>	105186	53
19	Schneckensatz <i>Worm set</i>	105194	24
20	Drehgestell vorne komplett <i>Front bogie assembly</i>	105204	53
21	Getriebeatz 1 <i>Gear part set 1</i>	105205	24
22	Kontakthalter <i>Contact holder</i>	105206	2
23	Blende Lok <i>Bogie Loc</i>	105207	20
24	Kupplungskammer <i>Coupling chamber</i>	105208	3
25	Zurüstbeutel <i>Bag with accessories</i>	105209	12
26	Drehgestell hinten komplett Dummy <i>Rear bogie assembly Dummy</i>	105211	30
27	Drehgestell vorne komplett Dummy <i>Front bogie assembly Dummy</i>	105212	30
28	Blende Dummy <i>Bogie frame Dummy</i>	105216	20
29	Kupplungskammer Dummy <i>Coupling chamber frame Dummy</i>	105217	3
30	Halteclips Dummy <i>Coupling shackle Dummy</i>	105218	2
31	Drehgestell Mittelwagen <i>Intermediate trailer bogie</i>	105220	29

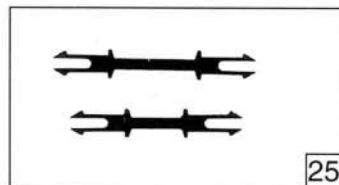

31 o. Abb. / no ill.
Drehgestell Mittelwagen
Intermediate trailer bogie

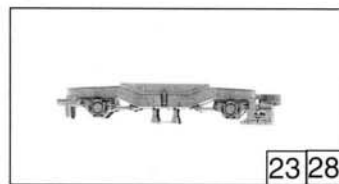
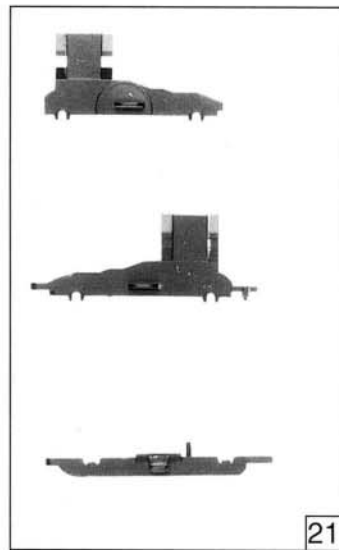
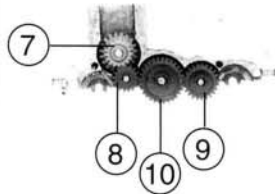
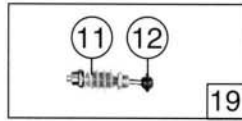