

Original ROCO-Ersatzteile Original ROCO Replacement Parts

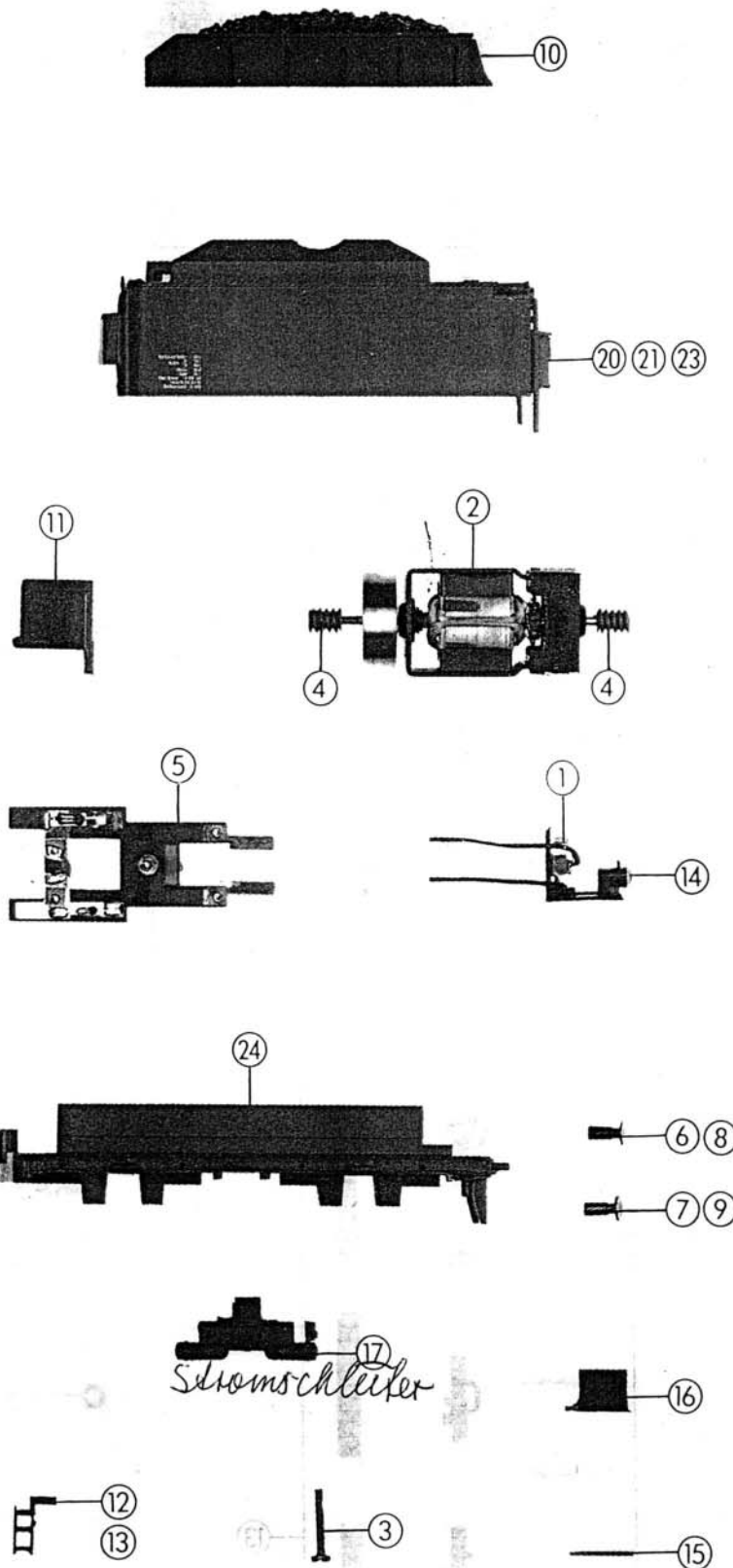

BR01 43240
BR01 43242
BR01 43243



Stromschleifer

- o. Abb. no ill.
- 22 Tender kpl. f. 43240
Tender ass. f. 43240
 - 18 Tender kpl. f. 43242
Tender ass. f. 43242
 - 19 Tender kpl. f. 43243
Tender ass. f. 43243

Pos. Nr.	Art.-Nr. neu	Art.-Nr. alt	Text	Preis-Gruppe
1	10021	4572S-001	Lampe St. 2, 8 <i>Lamp St. 2, 8</i>	99
2	85078	0925	Motor <i>Motor</i>	99
3	85677	81000B-258	Schraube M 2x14 <i>Screw M 2x14</i>	2
4	86703	4112S-152	Schnecke <i>Worm</i>	4
5	87711	—	Tenderplatte <i>Tender contact plate ass.</i>	28
6	88521	4120A-400	Puffer flach, bedruckt <i>Buffer flat, painted</i>	6
7	88522	4120A-401	Puffer gewölbt, bedruckt <i>Buffer vaulted, painted</i>	6
8	88556	4120S-400	Puffer flach <i>Buffer flat</i>	4
9	88557	4120S-401	Puffer gewölbt <i>Buffer vaulted</i>	4
10	92180	4119S-032	Kohlenaufsatz <i>simulted coal</i>	15
11	92200	4119S-064	Schwenktüre <i>swivel door</i>	6
12	92209	4119S-096	Tenderleiter links <i>Ladder Tender left</i>	3
13	92210	4119S-097	Tenderleiter rechts <i>Ladder Tender right</i>	3
14	92212	4119S-099	Tenderlaterne <i>Lantern Tender</i>	3
15	92231	4119S-203	Isolierplatte <i>Insulator plate</i>	2
16	92232	4119S-204	Kupplungsisolierkammer <i>coupling isolations board</i>	2
17	93938	—	Behälter und Kontakt <i>Tank and contact</i>	10
18	94542	—	Tender kpl. f. 43242 <i>Tender ass. f. 43242</i>	83
19	94543	—	Tender kpl. f. 43243 <i>Tender ass. f. 43243</i>	83
20	94544	—	Tenderoberteil für 43242 <i>Tender upper part for 43242</i>	41
21	94545	—	Tenderoberteil für 43243 <i>Tender upper part for 43243</i>	41
22	94557	—	Tender kpl. f. 43240 <i>Tender ass. for 43240</i>	83
23	94558	—	Tenderoberteil für 43240 <i>Tender upper part for 43240</i>	41
24	94565	—	Tenderunterteil <i>Tender lower part</i>	30