

Original ROCO-Ersatzteile Original ROCO Replacement Parts

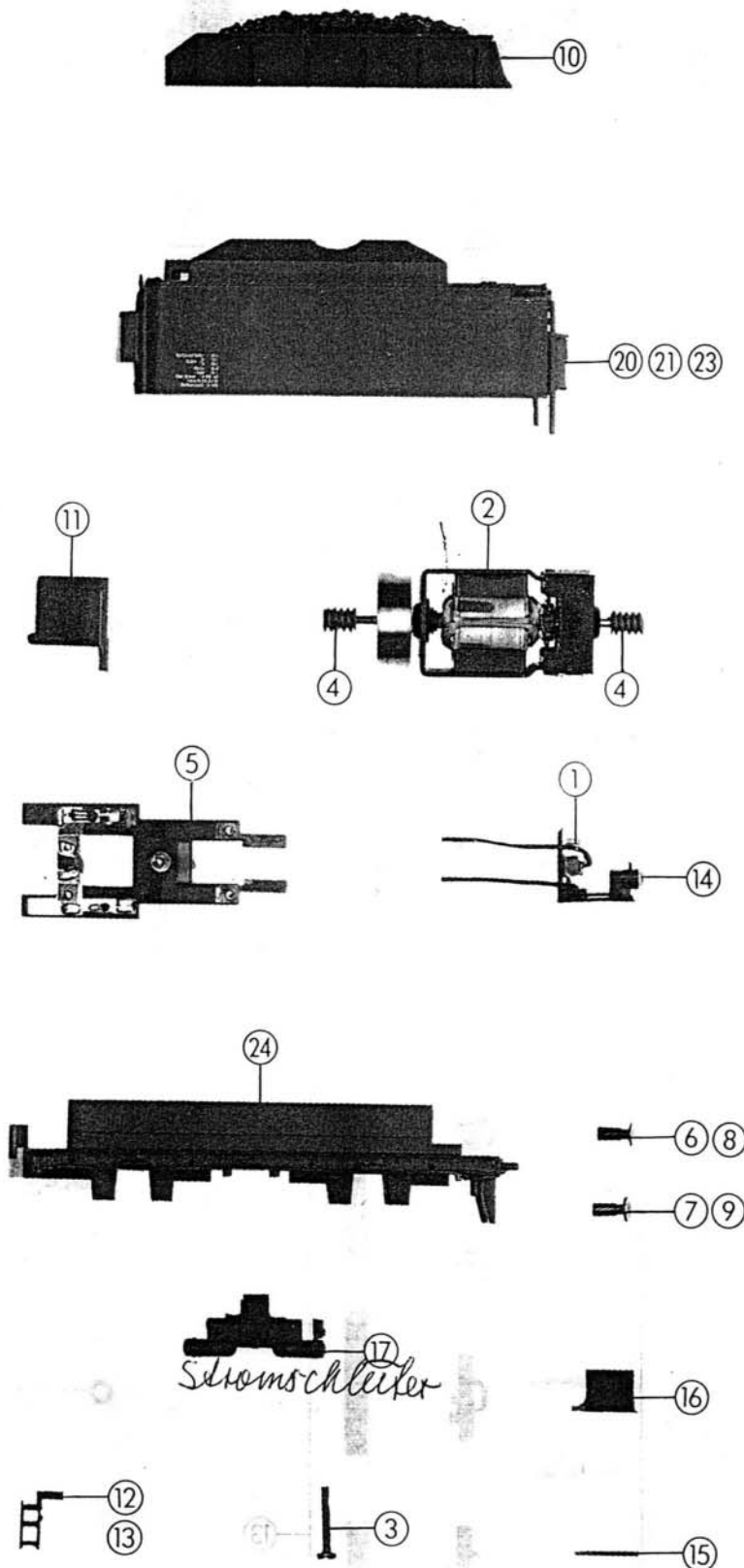

BR01 43240
BR01 43242
BR01 43243



o. Abb. no ill. **22** Tender kpl. f. 43240
Tender ass. f. 43240
18 Tender kpl. f. 43242
Tender ass. f. 43242
19 Tender kpl. f. 43243
Tender ass. f. 43243

Pos. ze.	Art.-Nr. neu	Art.-Nr. alt	Text	Preis- gründe
1	10021	4572S-001	Lampe St. 2, 8 Lamp St. 2, 8	99
2	85078	0925	Motor Motor	99
3	85677	81000B-258	Schraube M2x14 Screw M2x14	2
4	86703	4112S-152	Schnecke Worm	4
5	87711	—	Tenderplatine Tender contact plate ass.	28
6	88521	4120A-400	Puffer flach, bedruckt Buffer flat, painted	6
7	88522	4120A-401	Puffer gewölbt, bedruckt Buffer vaulted, painted	6
8	88556	4120S-400	Puffer flach Buffer flat	4
9	88557	4120S-401	Puffer gewölbt Buffer vaulted	4
10	92180	4119S-032	Kohlenaufsatz simulted coal	15
11	92200	4119S-064	Schwenktüre swivel door	6
12	92209	4119S-096	Tenderleiter links Ladder Tender left	3
13	92210	4119S-097	Tenderleiter rechts Ladder Tender right	3
14	92212	4119S-099	Tenderlaterne Lantern Tender	3
15	92231	4119S-203	Isolierplatte Insulator plate	2
16	92232	4119S-204	Kupplungsisolierkammer coupling isolations board	2
17	93938	—	Behälter und Kontakt Tank and contact	10
18	94542	—	Tender kpl. f. 43242 Tender ass. f. 43242	83
19	94543	—	Tender kpl. f. 43243 Tender ass. f. 43243	83
20	94544	—	Tenderoberteil für 43242 Tender upper part for 43242	41
21	94545	—	Tenderoberteil für 43243 Tender upper part for 43243	41
22	94557	—	Tender kpl. f. 43240 Tender ass. for 43240	83
23	94558	—	Tenderoberteil für 43240 Tender upper part for 43240	41
24	94565	—	Tenderunterteil Tender lower part	30