

| Pos.-Nr. | Art.-Nr. | Text | Preisgruppe |
|----------|----------|--|-------------|
| 1 | 10026 | Glühlampe weiß Light bulb white | 99 |
| 2 | 85604 | Hafttring f. 43484 Traction tyre f. 43484 | 99 |
| 3 | 85614 | Hafttring f. 43485 Traction tyre f. 43485 | 99 |
| 4 | 85670 | Zylinderkopfschraube M2x4 Cheese headed screw M2x4 | 2 |
| 5 | 85723 | Drehgestellschraube Bogie screw | 2 |
| 6 | 86202 | Feder Spring | 2 |
| 7 | 86409 | Zahnrad z 17; m 0,4 Gear T 17; m 0,4 | 2 |
| 8 | 86416 | Zahnrad z 14/19; m 0,4 Gear T 14/19; m 0,4 | 3 |
| 9 | 86417 | Zahnrad z 19; m 0,4 Gear T 19; m 0,4 | 2 |
| 10 | 86467 | Zahnrad z 29; m 0,4 Gear T 29; m 0,4 | 2 |
| 11 | 86470 | Zahnrad z 12; m 0,4 Gear T 12; m 0,4 | 2 |
| 12 | 86703 | Schnecke m 0,4 Worm m 0,4 | 4 |
| 13 | 87062 | Kardanwelle Cardan axle | 2 |
| 14 | 87063 | Kardanschale Cardan bearing | 3 |
| 15 | 88504 | Puffer gewölbt Buffer vaulted | 4 |
| 16 | 88505 | Puffer flach Buffer flat | 4 |
| 17 | 89246 | Standardkupplung Standard coupling | 5 |
| 18 | 89700 | Achse 2,6x9,3 Axle 2,6x9,3 | 2 |
| 19 | 89701 | Achse 2,6x11,5 Axle 2,6x11,5 | 2 |
| 20 | 89830 | Schneckensatz kpl. Worm set assembly | 24 |
| 21 | 89853 | Radkontakt kpl. Wheel current contact ass. | 12 |
| 22 | 89854 | Lampenkontakt kpl. Light bulb contact assembly | 20 |
| 23 | 89897 | Selenplättchen Ø 5 mm Diode Ø 5 mm | 8 |
| 24 | 90238 | Radsatz f. 43484 Wheelset f. 43484 | 16 |
| 25 | 90239 | Radsatz m. Hafttring f. 43484 Wheelset w. tract. tyre f. 43484 | 16 |
| 26 | 90376 | Radsatz f. 43485 Wheelset f. 43485 | 16 |
| 27 | 90377 | Radsatz m. Hafttring f. 43485 Wheelset w. tract. tyre f. 43485 | 16 |
| 28 | 93023 | Getriebe kpl. f. 43485 Gear assembly f. 43485 | 58 |
| 29 | 93040 | Getriebekasten Gear box | 29 |
| 30 | 93060 | Getriebe kpl. f. 43484 Gears assembly f. 43484 | 58 |
| 31 | 93061 | DG-Blende 1 kpl., schwarz Bogie frame 1 assy., black | 28 |
| 32 | 93062 | DG-Blende 2 kpl., schwarz Bogie frame 2 assy., black | 28 |
| 33 | 93063 | Steckteile-Satz f. Blende 1, schwarz Parts set f. bogie 1, black | 18 |
| 34 | 93064 | Steckteile-Satz f. Blende 2, schwarz Parts set f. bogie 2, black | 18 |
| 35 | 93065 | Zurüstbeutel f. 43484 Bag with accessories f. 43484 | 26 |
| 36 | 93077 | Lichtleitstab Light transmissions bar | 3 |
| 37 | 93079 | Schneckendeckel Worm cover | 4 |
| 38 | 93081 | Kupplungshalter Coupling holder | 2 |
| 39 | 93085 | Getriebedeckel Gears cover | 18 |
| 40 | 93736 | DG-Blende 1 kpl., grau Bogie frame 1 assy., grey | 28 |
| 41 | 93737 | DG-Blende 2 kpl., grau Bogie frame 2 assy., grey | 28 |
| 42 | 93738 | Steckt.-Satz f. Blende 1, grau Parts set f. bogie 1, grey | 18 |
| 43 | 93739 | Steckt.-Satz f. Blende 2, grau Parts set f. bogie 2, grey | 18 |
| 44 | 93746 | Zurüstbeutel f. 43485 Bag with accessories | 26 |

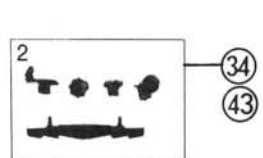
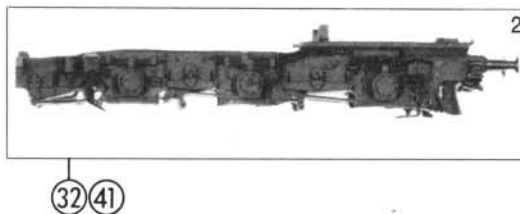
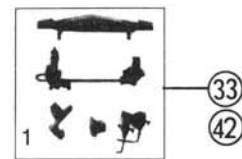
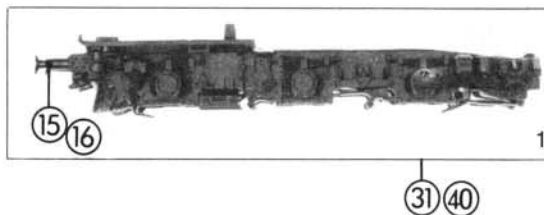
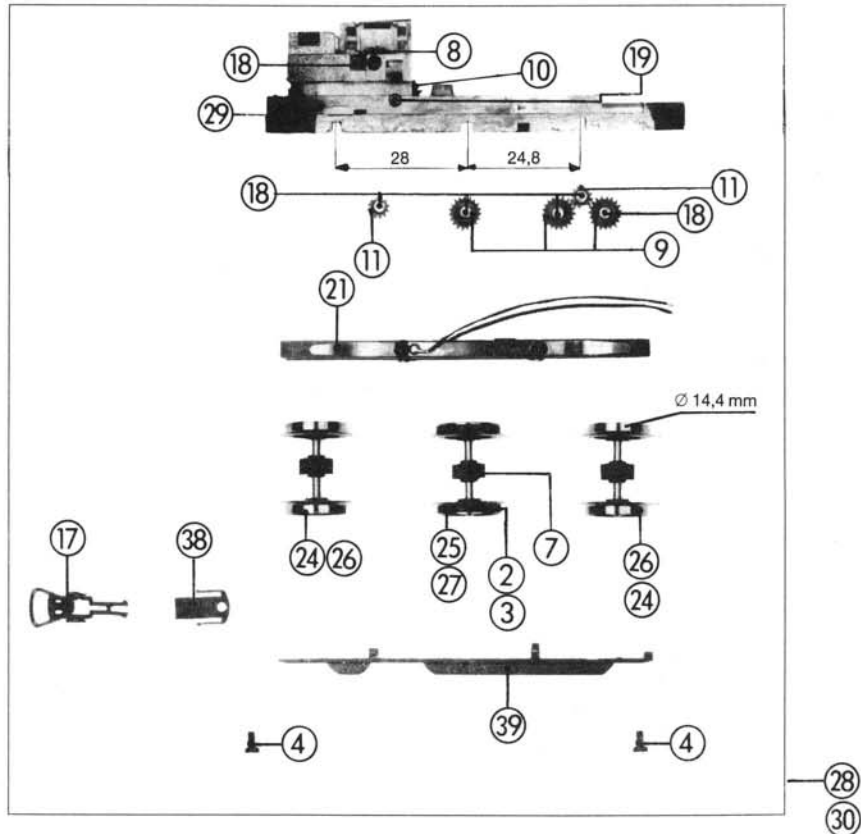
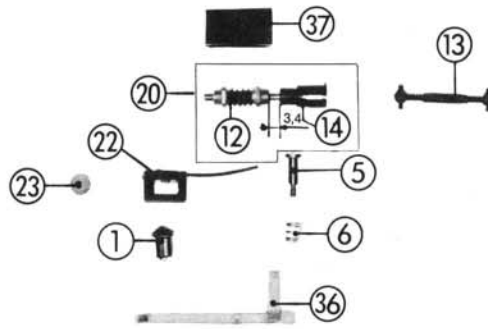

- 35 Zurüstbeutel f. 43484 (o. Abb.)
Bag with accessories f. 43484 (no. ill.)
 - 44 Zurüstbeutel f. 43485 (o. Abb.)
Bag with accessories (no. ill.)
- } siehe Betriebsanleitung
see operator's manual