

43491 43512  
 43492 43921  
 43493 43922  
 43494

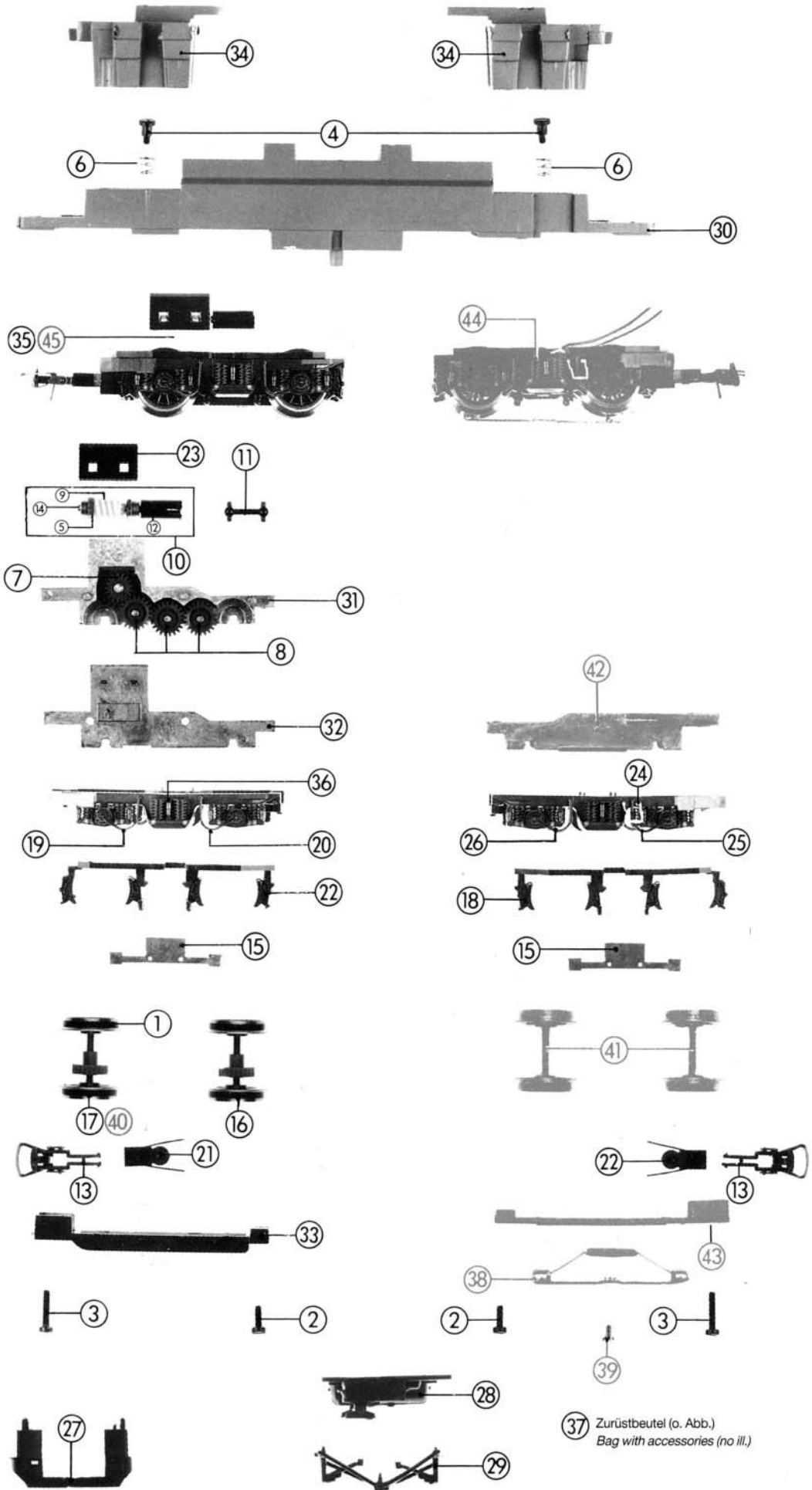

# Original ROCO-Ersatzteile Original ROCO Replacement Parts

| Art.-Nr. neu | Art.-Nr. alt | Text  | Preis-gruppe |
|--------------|--------------|---|--------------|
| 1            | 85604        | 4689S<br>Hafttring<br>Traction tyre                                     | 99           |
| 2            | 85673        | 81000B-253<br>Zylinderkopfschraube M2x7<br>Cheese headed screw M2x7     | 2            |
| 3            | 85675        | 81000B-256<br>Zylinderkopfschraube M2x10<br>Cheese headed screw M2x10   | 2            |
| 4            | 85704        | 4183S-420<br>Ansatzschraube M2x2,8<br>Set screw M2x2,8                  | 3            |
| 5            | 86081        | 81200G<br>Beilagscheibe<br>Washer                                       | 2            |
| 6            | 86202        | 4149S-066<br>Druckfeder<br>Compression spring                           | 2            |
| 7            | 86413        | 4178S-190<br>Schneckenrad z17; m0,4<br>Worm gearing T17; m0,4           | 4            |
| 8            | 86414        | 4178S-191<br>Zahnrad z21; m0,4<br>Gear T21; m0,4                        | 3            |
| 9            | 86702        | 4178S-195<br>Schnecke m0,5<br>Worm m0,5                                 | 5            |
| 10           | 86832        | 4178S-A65<br>Schneckensatz komplett<br>Worm set assembly                | 24           |
| 11           | 87064        | 4178S-006<br>Kardanwelle<br>Cardan shaft                                | 2            |
| 12           | 87065        | 4178S-007<br>Kardanschale kurz<br>cardan shaft                          | 3            |
| 13           | 89246        | 4612S<br>Standardkupplung<br>Standart coupling                          | 99           |
| 14           | 89749        | 4154S-049<br>Schneckenachslager<br>Worm axle bearing                    | 6            |
| 15           | 89856        | 4178S-300<br>Radkontakt<br>Wheel current contact strip                  | 3            |
| 16           | 90242        | 4178S-A06<br>Radsatz mit Haftreifen<br>Wheelset with traction tyre      | 16           |
| 17           | 90243        | 4178S-A07<br>Radsatz<br>Wheelset  | 16           |
| 18           | 93128        | 4178S-009<br>Bremsbacken, rechts<br>Brake shoes, right                  | 8            |
| 19           | 93129        | 4178S-010<br>Fühlerleitung, links, vorne<br>Tracer cable, left, front   | 2            |
| 20           | 93130        | 4178S-011<br>Fühlerleitung, links, hinten<br>Tracer cable, left, rear   | 2            |
| 21           | 93131        | 4178S-012<br>Kupplungshalter<br>Coupling holder                         | 2            |
| 22           | 93132        | 4178S-013<br>Bremsbacken, links<br>Brake shoes, left                    | 8            |
| 23           | 93133        | 4178S-017<br>Schneckendeckel<br>Worm cover                              | 4            |
| 24           | 93134        | 4178S-018<br>Auftritt<br>Step   | 2            |
| 25           | 93136        | 4178S-025<br>Fühlerleitung, rechts, vorne<br>Tracer cable, right, front | 2            |
| 26           | 93137        | 4178S-026<br>Fühlerleitung, rechts, hinten<br>Tracer cable, right, rear | 2            |
| 27           | 93140        | 4178S-037<br>Schienenräumer<br>Track clearer                            | 6            |
| 28           | 93141        | 4178S-039<br>Batteriekasten<br>Battery container                        | 8            |
| 29           | 93147        | 4178S-047<br>Gestänge<br>Linkage  | 10           |
| 30           | 93149        | 4178S-200<br>Rahmen<br>Frame  | 30           |
| 31           | 93150        | 4178S-201<br>Getriebekasten<br>Gear case                                | 25           |
| 32           | 93151        | 4178S-202<br>Getriebedeckel<br>Gear cover                               | 10           |
| 33           | 93152        | 4178S-203<br>Getriebeboden<br>Gears bottom                              | 16           |
| 34           | 93153        | 4178S-204<br>Gewicht<br>Weight  | 22           |
| 35           | 93159        | 4178S-A03<br>Drehgestell komplett<br>Bogie assembly                     | 56           |
| 36           | 93160        | 4178S-A05<br>Drehgestellblende kpl.<br>Bogie frame assembly             | 37           |
| 37           | 93161        | 4178S-A15<br>Zurüstbeutel<br>Bag with accessories                       | 32           |
| 38           | 40003        | 4660S<br>Schischleifer<br>Collector shoe                                | 99           |
| 39           | 85685        | 81001A-205<br>Zylinderkopfschr. M1,7x3,5<br>Cheese head. scr. M1,7x3,5  | 2            |
| 40           | 90309        | 14178S-A06<br>Radsatz mit Zahnrad<br>Wheelset with gear                 | 16           |
| 41           | 90806        | 14178S-A07<br>Radsatz<br>Wheelset                                       | 14           |
| 42           | 93581        | 14178S-201<br>Drehgestellrahmen<br>Bogie frame                          | 25           |
| 43           | 93582        | 14178S-202<br>Schleiferträger<br>Collector shoe carrier                 | 10           |
| 44           | 93583        | 14178S-A03<br>Triebdrehgestell<br>Driving bogie                         | 56           |
| 45           | 93584        | 14178S-A04<br>Drehgestell<br>Bogie                                      | 49           |



37 Zurüstbeutel (o. Abb.)  
 Bag with accessories (no ill.)