

| Pos.-Nr. | Text | Art.-Nr. | Preisgruppe |
|----------|---|----------|-------------|
| 1 | Motor mit Schwungscheibe Motor with fly wheel | 85072 | 57 |
| 2 | Haltring 0,3 mm Traction tyre 0,3 mm | 85614 | 17 |
| 3 | Schraube M 2x6 Screw m 2x6 | 85672 | 2 |
| 4 | Schraube M 2x8 Screw M 2x8 | 85674 | 2 |
| 5 | Schraube M 2,2x2,8 Screw M 2,2x2,8 | 85704 | 5 |
| 6 | Feder Spring | 86202 | 2 |
| 7 | Zahnrad z=21, G. Gear T=21 straight | 86414 | 2 |
| 8 | Zahnrad z=17 Gear T=17 | 86418 | 2 |
| 9 | Zahnrad z=16/17 Gear T=16/17 | 86419 | 4 |
| 10 | Schnecke Worm | 86704 | 5 |
| 11 | Schneckensatz Worm set | 86865 | 24 |
| 12 | Kardanschale, kurz Cardan bearing, short | 87129 | 3 |
| 13 | Kardanwelle Cardan shaft | 87133 | 3 |
| 14 | Kardanschale (Schnecke) Cardan bearing (Worm) | 87134 | 3 |
| 15 | Standard Kupplung Standard coupling | 89246 | 5 |
| 16 | Kupplungskammer Coupling chamber | 89266 | 3 |
| 17 | Radkontakt Wheel contact | 89913 | 5 |
| 18 | Radsatz mit 1 Haftreifen Wheel set with 1 traction tyre | 90551 | 18 |
| 19 | Radsatz Wheel set | 90552 | 17 |
| 20 | Blende 1 komplett Bogie frame 1 assembly | 93878 | 28 |
| 21 | Blende 2 komplett Bogie frame 2 assembly | 93879 | 28 |
| 22 | Blendensteckteilesatz Bogie push in parts set | 93880 | 15 |
| 23 | Drehgestell 1 komplett Bogie 1 assembly | 93884 | 55 |
| 24 | Drehgestell 2 komplett Bogie 2 assembly | 93885 | 55 |
| 25 | Getriebekasten Gear box | 93887 | 18 |
| 26 | Getriebeboden Gear bottom | 93888 | 15 |
| 27 | Getriebedeckel Gear cover | 93889 | 15 |
| 28 | Zurüstbeutel 1 (Griffe) Bag with accessories 1 (handles) | 93890 | 18 |
| 29 | Zurüstbeutel 2 (Steckteile) Bag with accessories (Push in parts) | 93891 | 12 |
| 30 | Schneckendeckel Worm cover | 94679 | 3 |

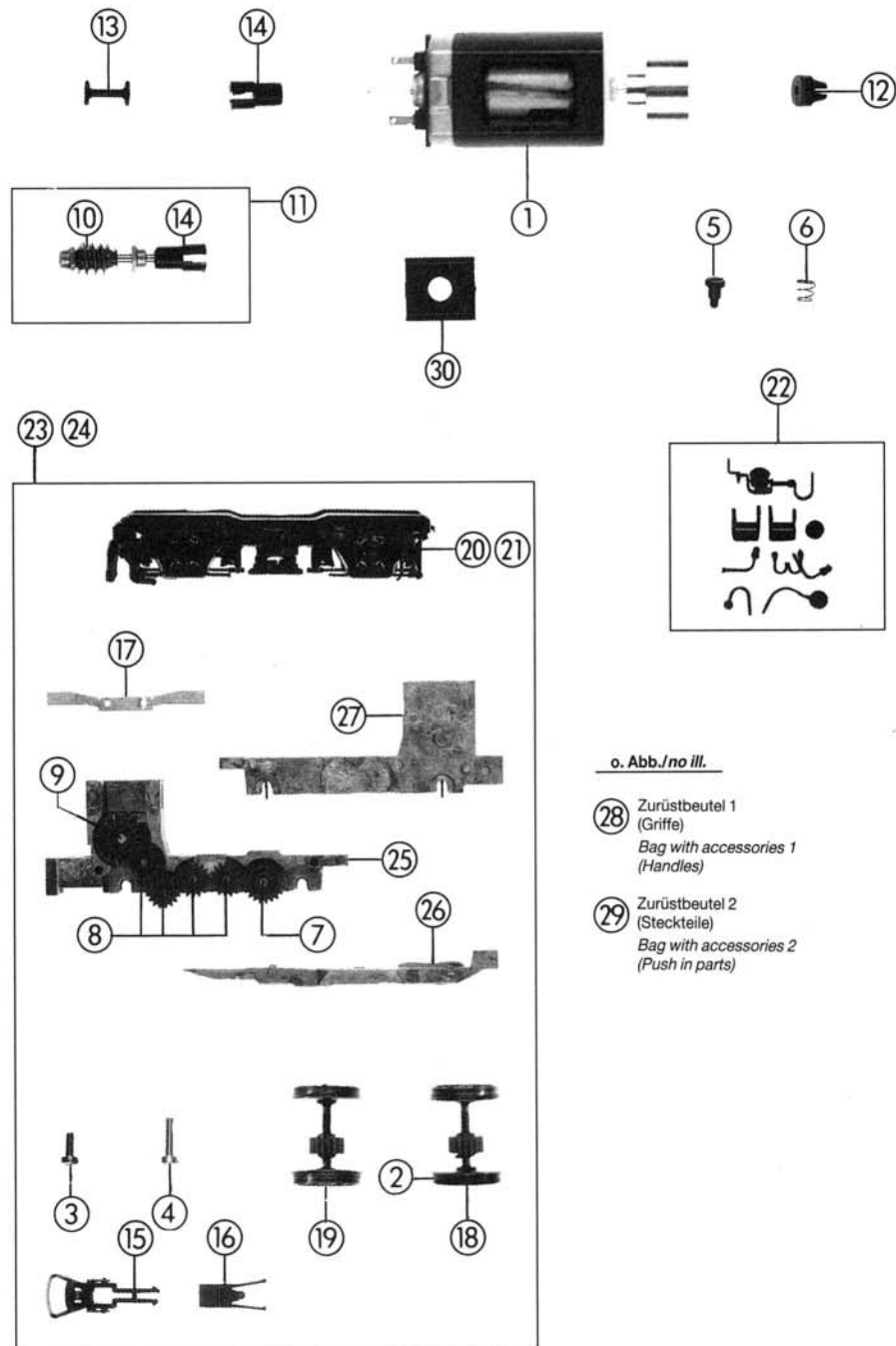

o. Abb./no ill.

- 28
 Zurüstbeutel 1
 (Griffe)
 Bag with accessories 1
 (Handles)
- 29
 Zurüstbeutel 2
 (Steckteile)
 Bag with accessories 2
 (Push in parts)