

Pos. N°	Text	Art.-Nr.	Preis- gruppe
1	Motor mit Schwungscheibe <i>Motor with flywheel</i>	85060	57
2	Haftring <i>Traction tyre</i>	85614	17
3	Schraube M 2 x 6 <i>Screw M 2 x 6</i>	85672	2
4	Schraube M 2 x 8 <i>Screw M 2 x 8</i>	85674	2
5	Schraube M 2 x 2,8 <i>Screw M 2 x 2,8</i>	85704	5
6	Feder <i>Spring</i>	86202	2
7	Zahnrad z=21, G <i>Gear T=21 straight</i>	86414	2
8	Zahnrad z=17 <i>Gear T=17</i>	86418	2
9	Zahnrad z=16/17 <i>Gear T=16/17</i>	86419	4
10	Schnecke <i>Worm</i>	86704	5
11	Schneckensatz <i>Worm set</i>	86865	24
12	Kardanschale kurz <i>Cardan bearing short</i>	87129	3
13	Kardanwelle <i>Cardan shaft</i>	87133	3
14	Kardanschale <i>Cardan bearing</i>	87134	3
15	Standard Kupplung <i>Standard coupling</i>	89246	5
16	Kupplungskammer <i>Coupling chamber</i>	89266	3
17	Radkontakt <i>Wheel chamber</i>	89913	5
18	Radsatz mit 1 Haftring <i>Wheelset with traction tyre</i>	90575	20
19	Radsatz <i>Wheel set</i>	90576	18
20	Getriebekasten <i>Gear box</i>	93887	18
21	Getriebeboden <i>Gear bottom</i>	93888	15
22	Getriebedeckel <i>Gear cover</i>	93889	15
23	Schneckendeckel <i>Worm cover</i>	94679	3
24	Bahnräumer für 43642 <i>Pilot plow</i>	94784	4
25	Drehgestell 1 komplett <i>Bogie 1, assembly</i>	94785	55
26	Drehgestell 2 komplett <i>Bogie 2, assembly</i>	94786	55
27	Zurüstbeutel 2 Steckteile <i>Bag with accessories 2 (push in part)</i>	94789	24
28	Blende 1 komplett <i>Bogie frame 1 assembly</i>	94791	28
29	Blende 2 komplett <i>Bogie frame 2 assembly</i>	94792	28
30	Blendesteckteilesatz <i>Bogie push in parts set</i>	94795	15
31	Bahnräumer für 43643 <i>Pilot frame dor 43643</i>	94815	4
32	Zurüstbeutel für 43642 n. Austria <i>Bag with accessories for 43642 n. Austria</i>	101124	28
33	Zurüstbeutel Griffe für 43643 <i>Bag with accessories</i>	101125	26

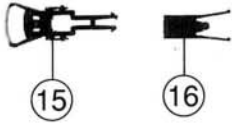

25 26

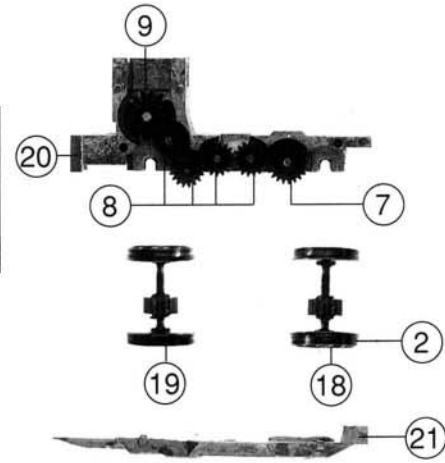
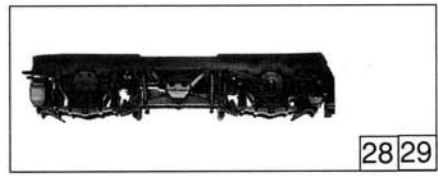
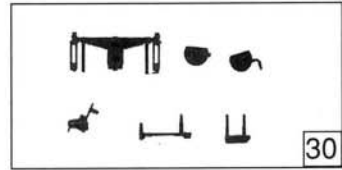
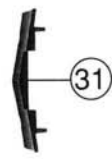
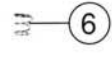
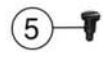
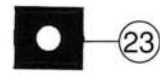
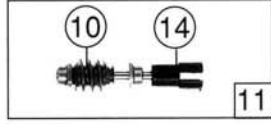
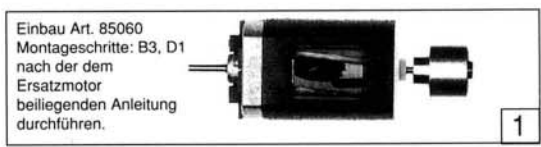
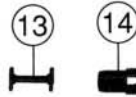