

Pos. Nr.	Text	Art.-Nr.	Preis-gruppe
1	Hafring f. Dc Traction tyre	85612	17
2	Zahnrad z = 17/0,4 G Gear z = 17/0,4G	86418	2
3	Schnecken Zahnrad f. DC Gear	86419	4
4	Zahnrad Gear	86460	2
5	Zwischenzahnrad Gear	86480	2
6	Schnecke f. DC Worm f. DC	86704	5
7	Kardanschale Cardan Bearing	87152	2
8	Standardkupplung Standard coupling	89246	5
9	Radkontakt Wheel current contact	89956	4
10	Radsatz o. Hafring Wheel without traction	90893	18
11	Radsatz m. 2 Hafringen Wheelset with traction	90894	20
12	Teilsatz 1 Part set 1	101234	28
13	Leiter Step	101237	3
14	Kontakthalter Contact holder	101239	5
15	Teilsatz 2 Part Set 2	101240	11
16	Drehgestell komplett Bogie assembly	101241	53
17	Schneckensatz Worm set	101242	24
18	Getriebebesatz Gear part set	101244	18
19	Deckel DC Cover DC	101245	5
20	Zurüstbeutel Bag with accessoires	101246	26
21	Kupplungskammer Coupling holder	101452	2
22	Schleifer Collector shoe	40003	-
23	Hafring f. AC Traction tyre	85618	17
24	Schraube 1,6 x 5 Screw 1,6 x 5	85692	2
25	Schnecken Zahnrad f. AC Gear f. AC	86413	4
26	Schnecke f. AC Worm f. AC	86702	5
27	Radsatz o. Zahnrad Wheelset without gear	90895	16
28	Radsatz m. 2 Hafringen Wheelset with traction	90896	20
29	Drehgestell 1 Bogie assembly 1	101252	56
30	Schneckensatz Worm set	101253	24
31	Deckel AC Cover AC	101254	8
32	Getriebe Gears	101255	12
33	Drehgestell 2 Bogie assembly 2	101256	49

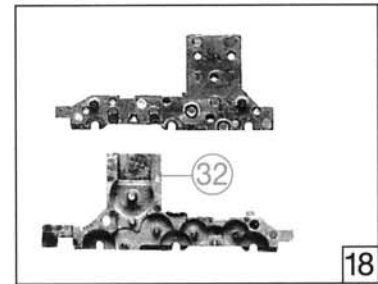

27
o. Abb. / no. ill.
Radsatz o. Zahnrad
Wheelset without gear

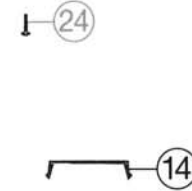
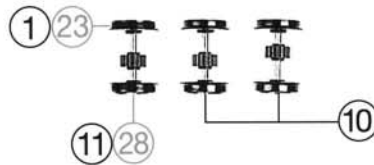
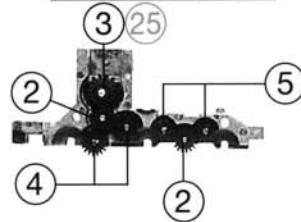
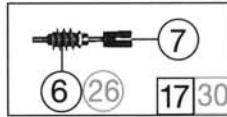
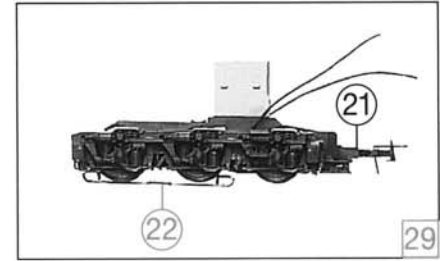
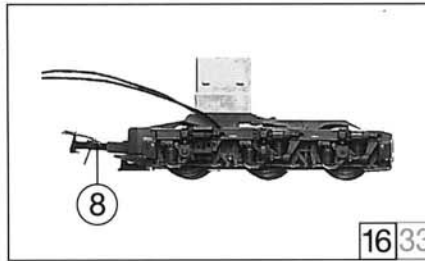