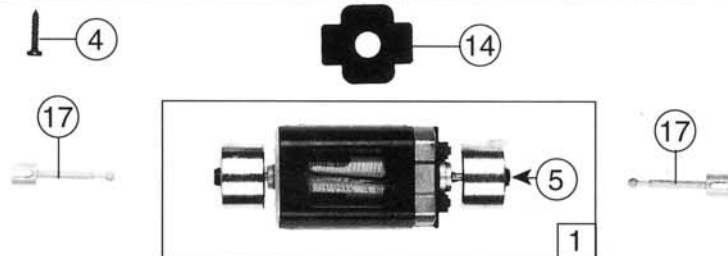
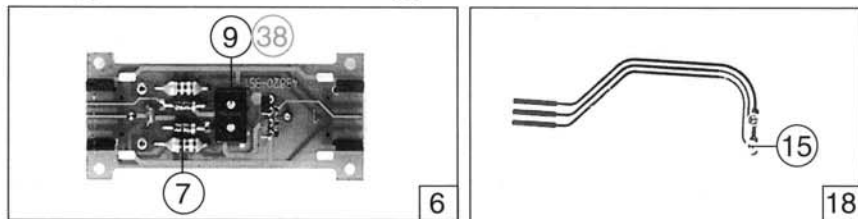
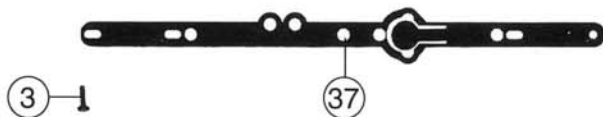
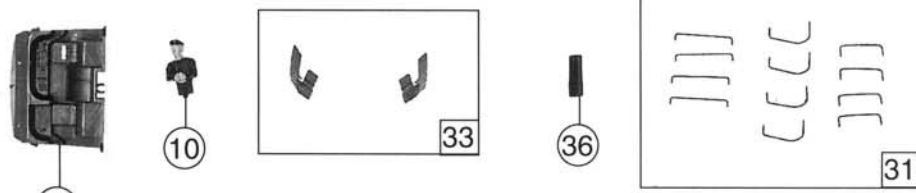
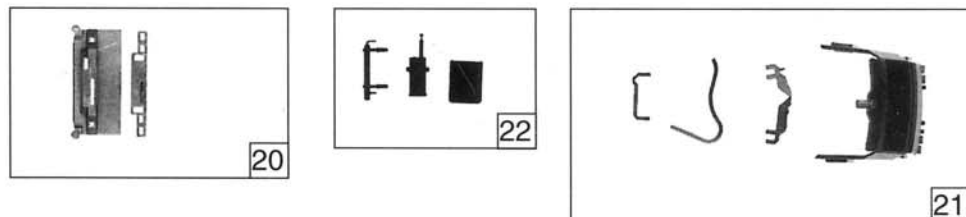
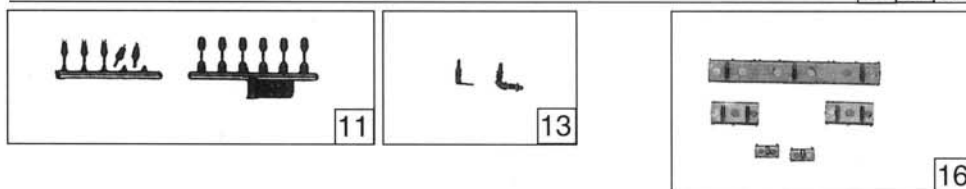

**19 34 35**

| Pos. Nr. | Text   | Art.-Nr. | Preis-gruppe |
|----------|--|----------|--------------|
| 1        | Motor<br><i>Motor</i>  | 85111    | 57           |
| 2        | Stromabnehmer<br><i>Pantograph</i>   | 85330    | 39           |
| 3        | Schraube M 1,6 x 5<br><i>Screw M 1,6 x 5</i>   | 85692    | 2            |
| 4        | Schraube 2,2 x 9,5<br><i>Screw 2,2 x 9,5</i>   | 85799    | 2            |
| 5        | Kardanschale kurz<br><i>Cardan bearing short</i>   | 87129    | 3            |
| 6        | Platine komplett<br><i>Printed circuit assembly</i>  | 87838    | 38           |
| 7        | Diode<br><i>Diode</i>  | 89898    | 8            |
| 8        | Antenne<br><i>Antenna</i>  | 94804    | 2            |
| 9        | Brückenstecker<br><i>Connector</i>   | 100644   | 7            |
| 10       | E-Lokführer<br><i>E-Driver</i>   | 101208   | 5            |
| 11       | Isolator Satz<br><i>Insulator set</i>  | 105176   | 12           |
| 12       | Puffer flach<br><i>Buffer flat</i>   | 105420   | 3            |
| 13       | Isolatorsatz<br><i>Insulator set</i>   | 106109   | 7            |
| 14       | Distanzplättchen<br><i>Spacer</i>  | 106116   | 2            |
| 15       | Drahtlampe<br><i>Light bulb</i>  | 106755   | 10           |
| 16       | Teilesatz<br><i>Parts set</i>  | 107009   | 13           |
| 17       | Kardanwelle<br><i>Cardan shaft</i>   | 107011   | 4            |
| 18       | Lampen - Flexplatine<br><i>Bulb printed</i>  | 107012   | 26           |
| 19       | Gehäuse komplett für 43820, 43860<br>Betr. Nr. 1014 008-5<br><i>Body assembly for 43820, 43860</i><br>Betr. No. 1014 008.5 | 107016   | 70           |
| 20       | Lichtabdeckungssatz<br><i>Light cover set</i>  | 107023   | 7            |
| 21       | Fenster-Lichtleitersatz<br><i>Set of windows and light emission</i>  | 107024   | 15           |
| 22       | Teilesatz<br><i>Partset</i>  | 107025   | 10           |
| 23       | Führerstand<br><i>Drivers cab</i>  | 107026   | 8            |
| 24       | Huppe kurz<br><i>Short horn</i>  | 107027   | 2            |
| 25       | Hebeantrieb<br><i>Lifting control</i>  | 107029   | 2            |
| 26       | Huppe lang<br><i>Short long</i>  | 107028   | 2            |
| 27       | Dachleitung kurz<br><i>Roof wire short</i>   | 107031   | 3            |
| 28       | Wandler<br><i>Converter</i>  | 107032   | 2            |
| 29       | Hauptschalterplatte<br><i>Main switch plate</i>  | 107033   | 2            |
| 30       | Isolator<br><i>Insulator</i>   | 107034   | 2            |
| 31       | Haltegriffsatz<br><i>Set of handrails</i>  | 107035   | 20           |
| 32       | Dachleitung lackiert<br><i>Roof wire painted</i>   | 107038   | 6            |
| 33       | Schutzblechsatz<br><i>Protection train set</i>   | 107040   | 9            |
| ★34      | Gehäuse komplett für 43820.1<br>Betr. Nr. 1014 010-1<br><i>Body assembly for 43820.1</i><br>Betr. No. 1014 010-1           | 107041   | 70           |
| ★35      | Gehäuse komplett für 43821, 43861<br>Betr. Nr. 1014 003-6<br><i>Body assembly for 43821, 43861</i><br>Betr. No. 1014 003-6 | 107060   | 70           |
| 36       | Schrumpfschlauch<br><i>Shrink hose</i>   | 107254   | 3            |
| 37       | Oberleitungskontakt<br><i>Overhead contact</i>   | 107261   | 6            |
| 38       | Brückenstecker<br><i>Connector</i>   | 100645   | 7            |